

INTEGRATIONS AND CONNECTED SYSTEMS

NO CODING NECESSARY. CONNECT TO OTHER SYSTEMS SIMPLY BY FILLING OUT A FORM.

Let's face it, getting systems to talk to each other is hard. But Appian makes it easy. Designers can take advantage of two features in Appian: Integrations and Connected Systems. These work in tandem to make connecting Appian to other systems walk-up easy.

Appian guides you through the integration process every step of the way. Start with the system you need to test with, the credentials you need to use, and test whether a connection can be made.

Not sure what parameters or headers to use? Appian Integrations provide designers with an integration test suite that gives you a formatted response in the same UI that your coding in. This is much better and faster than using a command line tool, or running snippets of code to see if you've got everything configured properly.

KEY FEATURES

- Familiar Reusable Authentication and Endpoints
- Guided Configuration Steps
- OAuth 2.0 & OpenAPI 3.0 Support
- Popular Out-of-the-Box Connections Built-In
- Integrated API Testing Suite
- Custom Response Error Handling

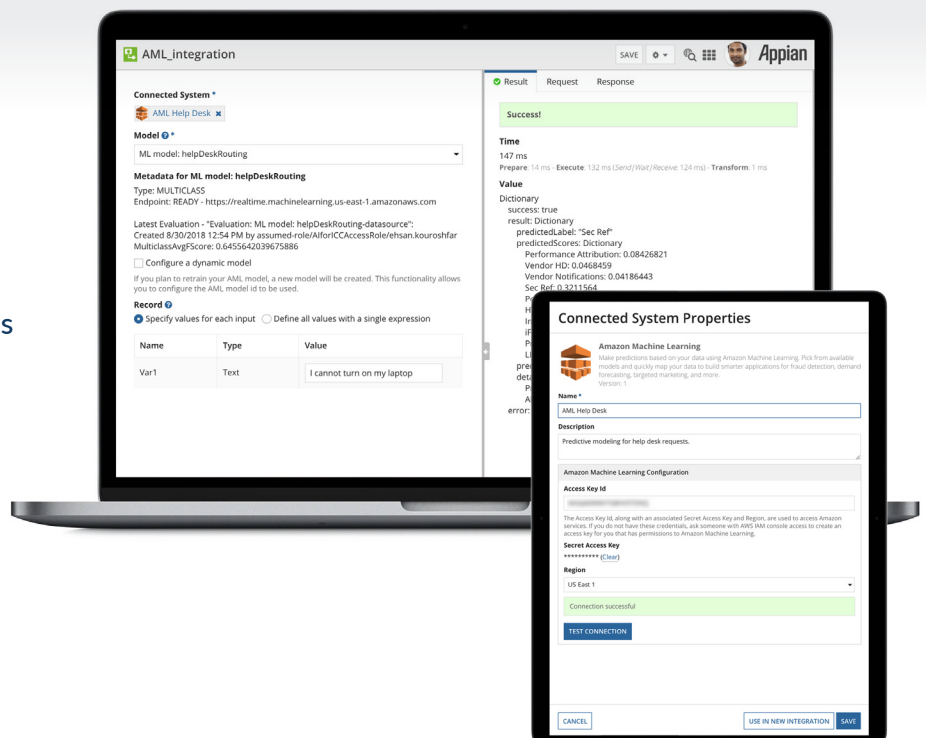

INTEGRATIONS AND CONNECTED SYSTEMS

CONNECTED SYSTEMS

The Connected System is a great starting point for any integration. It stores properties such as an endpoint and credentials, allowing Designers to test those connections, and reuse known values across any Integration that wants to use them.

What's more, connected systems come with a bunch of power out-of-the-box templates such as, Amazon Machine Learning, Blue Prism, and many others. If selected, Designers can create customized integrations tailor fit to each 3rd-party service.

OPENAPI SUPPORTED

Appian Integrations support the use of the OpenAPI Standard (<https://ap.pn/2FgUFkj>). If a service provides an OAS file, simply upload that file in a connected system, and make any API call simply by choosing the method in a single dropdown.

BUILT IN API TESTING

Probably the biggest reason why connecting with other systems is hard is due to not having a good testing capabilities. This is eliminated in Appian by having built-in test features. There are a number of reasons why a connection could fail—improper authentication, a service being down, or using incorrect parameters. With Appian, you can easily determine why a connection isn't working.

ENTERPRISE GRADE

Integrations can do a lot. **A lot.** All HTTP methods are supported out of the box, letting you properly connect to most environments. Alone, this is important, but Appian also gives you the ability to automatically convert the response body into several different data types. Additionally, Designers can create custom error handling for each integration, allowing for powerful exception handling capabilities.

Integrations bring many more features to improve the design experience. Version history, a built-in diff checker, robust security, and concurrent design detection let designers see important details about the Integration and ensure that it functions within an enterprise-class application.

THE APPIAN LOW-CODE LIBRARY

Appian's low-code library is designed to help you understand what makes Appian tick. See what makes Appian low-code, and what makes our applications capable of meeting the most demanding enterprise use cases. You can see all this in action and try it out for yourself by enrolling in a free trial: [appian.com/platform/free-trial](https://www.appian.com/platform/free-trial)



Appian provides a software development platform that combines intelligent automation and low-code development to rapidly deliver powerful business applications. Many of the world's largest organizations use Appian applications to improve customer experience, achieve operational excellence, and simplify global risk and compliance.

For more information, visit www.appian.com